

CLUSTER FACTORY

70' x 150'

BUILT-UP 6,027 SQ.FT.

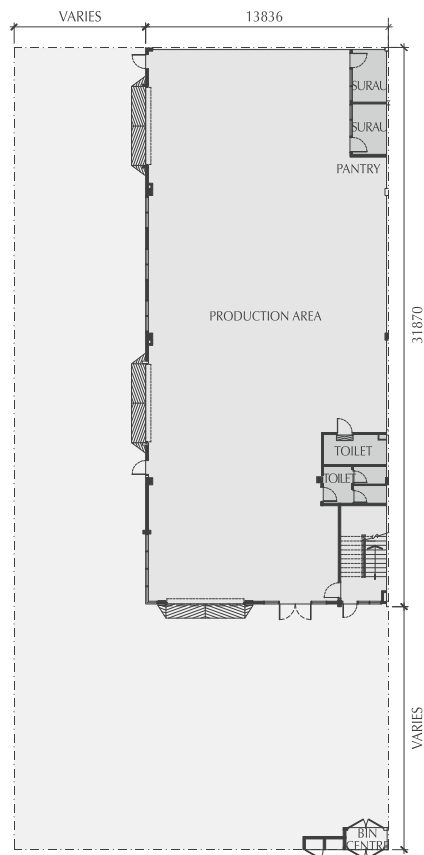

GROUND FLOOR

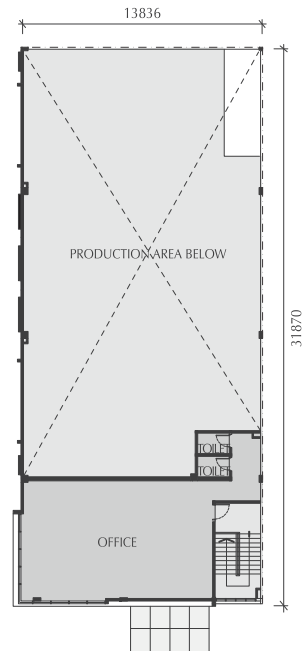

FIRST FLOOR

SPECIFICATIONS

CLUSTER FACTORY | 70'x150'

Structure	Reinforced concrete / Steel frame / Steel trusses	
Walls	Brick wall / Metal Cladding Wall / Concrete Wall	
Roof	Mainly metal deck roofing with suitable sisalation Reinforced concrete flat roof	
Ceiling	Plaster ceiling for office, where indicated	
Windows	Mainly aluminium-framed openable & fixed windows	
Doors	Metal roller shutter / Aluminium framed glass door / Flush door / Fire-rated door / Metal door with quality locks	
Wall Finishes and Painting	Weathershield paint or approved equivalent externally Emulsion paint internally / Semi gloss paint to wood and metal surfaces	
Floor Finishes	Tile finish for toilet & bin centre Cement rendering for others	
Sanitary and Water Supply Installation	Quality sanitary ware with fitting	
Electrical Installation	Three phase (setting at 150 Amp) 415-volts electricity supply Terminating at the main switchboard	
Gate and Fencing	Mild steel gate Brick wall	Bin centre BSP fencing

Note : All the above specifications are subject to change to comply with Governments Authorities / Engineers' and / or Architects' Requirements as and when deemed necessary.